

**Brighton & Hove
City Council
Schedule 12**

Part A

Regulation 33, 34

**Premises Licence
Brighton and Hove City Council**

Premises Licence Number

1445/3/2012/03269/LAPRET

Part I – Premises Details

Postal address of premises, or if none, ordnance survey map reference or description, including Post Town, Post Code

Paris House
21 Western Road
Hove
BN3 1AE

Telephone number 01273 724195

Licensable activities authorised by the licence

Performance of Live Music
Performance of Recorded Music
Performance of Dance
Anything of a similar description to live music, recorded music and performance of dance
Entertainment of a similar description to making music and dancing
Sale by Retail of Alcohol

Times the licence authorises the carrying out of licensable activities:-

Performance of Live Music - Indoors

Sunday – Thursday: 10.00 – 23.00

Friday – Saturday: 10.00 – 23.00

Live (acoustic/amplified) music and amplified voice, to finish one hour before the cessation of alcohol service. The use of live music is limited to short sessions at various times on different days throughout the week. The number of musicians may exceed two, subject to risk assessment. Performance of live music to be permitted from the start time on New Year's Eve until the finish time on the morning following New Year's Day. The sound attenuator shall be set at a level approved by



the Licensing Authority.

Performance of Recorded Music - Indoors

Sunday – Wednesday: 10.00 - 01.30

Thursday – Saturday: 10.00 - 02.30

Background music or DJ operated music, amplified and distributed through small speakers throughout the licensed area, volume controlled by the licensee. DJ operated music will cease an hour before closing when recorded music will switch to background level. The playing of recorded music to be permitted from the start time on New Year's Eve until the finish time on the morning following New Year's Day. The sound attenuator shall be set at a level approved by the Licensing Authority.

Performance of Dance - Indoors

Sunday – Thursday: 10.00 – 00.00

Friday – Saturday: 10.00 – 01.00

During performances of live music or entertainment of a similar description, performers to be permitted to enhance their act through demonstration or natural movement accompanying their music or act. Performance of dance to be permitted from the start time on New Year's Eve until the finish time on the morning following New Year's Day.

Anything of a similar description to live music, recorded music and performance of dance - Indoors

Sunday – Thursday: 10.00 – 00.00

Friday – Saturday: 10.00 – 01.00

Cabaret, comedians, spoken word and similar acts, acoustic or amplified voice. Performances of a similar description to be permitted from the start time on New Year's Eve until the finish time on the morning following New Year's Day.

Entertainment of a similar description to making music and dancing - Indoors

Sunday – Thursday: 10.00 – 00.00

Friday – Saturday: 10.00 – 01.00

Entertainment facilities to be provided from the start time on New Year's Eve until the finish time on the morning following New Year's Day. Microphone and jack input to sound system. All other equipment to be provided by the performers(s) subject to risk assessment. There will be no permanent, specified stage area for the performers(s).

Sale by Retail of Alcohol

Sunday – Thursday: 10.00 – 01.00

Friday – Saturday: 10.00 – 02.00

Sale of alcohol for consumption on the external seating will cease at 23.00.

Sale of alcohol to be permitted from the start time on New Year's Eve until the finish time on the morning following New Year's Day. On the occasion of a televised major live sporting event falling outside the hours granted to the premises licence, to have the option to open for the sale of alcohol one hour prior to the start of the event and to close one hour after the event finishes.

The opening hours of the premises

Sunday – Thursday: 10.00 – 01.30

Friday – Saturday: 10.00 – 02.30

PLUS: To be open to the public from the start time on New Year's Eve until the finish time on the morning following New Year's Day. On the occasion of a televised major live sporting event falling outside the hours granted to the premises licence, to have the option to open to the public one hour prior to the start of the event and to close one and a half hours after the event finishes.

The outside area shall be closed and cleared by 23:00. The external doors and windows shall be kept shut after 23:00, except for access and egress. The Licensee shall ensure that prominent, clear and legible notices are displayed at all exits requesting the public to respect the needs of local residents and to leave the premises and the area quietly.

Where the licence authorises supplies of alcohol whether these are on and / or off supplies

Alcohol is supplied for consumption both on and off the Premises.

Part 2

Name, (registered) address, telephone number and email (where relevant) of holder of premises licence

Rowbell Leisure LTD
Skid Mill House
Skid Mill Lane
Chrisham
Warlingham
Surrey
CR6 9PP

Registered number of holder, for example company number, charity number (where applicable)

Registered Business Number 06820717



**Brighton & Hove
City Council**

Name and address of designated premises supervisor where the premises licence authorises for the supply of alcohol

Ben Williams

REDACTED

Personal licence number and issuing authority of personal licence held by designated premises supervisor where the premises licence authorises for the supply of alcohol

Party Reference: REDACTED

Licensing Authority: Brighton & Hove City Council

Annex I - Mandatory conditions

S 19; mandatory conditions where licence authorises supply of alcohol

1. No supply of alcohol may be made under the premises licence
 - a) at a time when there is no designated premises supervisor in respect of the premises, or
 - b) at a time when the designated premises supervisor does not hold a personal licence or his personal licence is suspended
2. Every supply of alcohol under the premises licence must be made or authorised by a person who holds a personal licence
3. (1) The responsible person must ensure that staff on relevant premises do not carry out, arrange or participate in any irresponsible promotions in relation to the premises.
(2) In this paragraph, an irresponsible promotion means any one or more of the following activities, or substantially similar activities, carried on for the purpose of encouraging the sale or supply of alcohol for consumption on the premises-
 - (a) games or other activities which require or encourage, or are designed to require or encourage, individuals to-
 - (i) drink a quantity of alcohol within a time limit (other than to drink alcohol sold or supplied on the premises before the cessation of the period in which the responsible person is authorised to sell or supply alcohol), or
 - (ii) drink as much alcohol as possible (whether within a time limit or otherwise);
 - (b) provision of unlimited or unspecified quantities of alcohol free or for a fixed or discounted fee to the public or to a group defined by a particular characteristic in a manner which carries a significant risk of undermining a licensing objective;
 - (c) provision of free or discounted alcohol or any other thing as a prize to encourage or reward the purchase and consumption of alcohol over a period of 24 hours or less in a manner which carries a significant risk of undermining a licensing objective;
 - (d) selling or supplying alcohol in association with promotional posters or flyers on, or in the vicinity of, the premises which can reasonably be considered to condone, encourage or glamorise anti-social behaviour or to refer to the effects of drunkenness in any favourable manner.
 - (e) dispensing directly by one person into the mouth of another (other than where that other person is unable to drink without assistance by reason of a disability).
4. The responsible person must ensure that free potable water is provided on request to customers where it is reasonably available.
5. (1) The premises licence holder or club premises certificate holder must ensure that an age verification policy is adopted in respect of the premises in relation to the sale or supply of alcohol.
(2) The designated premises supervisor in relation to the premises licence must ensure that the supply of alcohol at the premises is carried on in accordance with the age verification policy.



**Brighton & Hove
City Council**

(3) The policy must require individuals who appear to the responsible person to be under 18 years of age (or such older age as may be specified in the policy) to produce on request, before being served alcohol, identification bearing their photograph, date of birth and either—

- (a) a holographic mark, or
- (b) an ultraviolet feature.

6. The responsible person must ensure that—

(a) where any of the following alcoholic drinks is sold or supplied for consumption on the premises (other than alcoholic drinks sold or supplied having been made up in advance ready for sale or supply in a securely closed container) it is available to customers in the following measures—

- (i) beer or cider: ½ pint;
- (ii) gin, rum, vodka or whisky: 25 ml or 35 ml; and
- (iii) still wine in a glass: 125 ml;

(b) these measures are displayed in a menu, price list or other printed material which is available to customers on the premises; and

(c) where a customer does not in relation to a sale of alcohol specify the quantity of alcohol to be sold, the customer is made aware that these measures are available.”

Minimum Drinks Pricing

1. A relevant person shall ensure that no alcohol is sold or supplied for consumption on or off the premises for a price which is less than the permitted price.

2. For the purposes of the condition set out in paragraph 1 —

- (a) “duty” is to be construed in accordance with the Alcoholic Liquor Duties Act 1979;
- (b) “permitted price” is the price found by applying the formula—

$$P=D+(D\times V)$$

where—

- (i) P is the permitted price,
- (ii) D is the amount of duty chargeable in relation to the alcohol as if the duty were charged on the date of the sale or supply of the alcohol, and
- (iii) V is the rate of value added tax chargeable in relation to the alcohol as if the value added tax were charged on the date of the sale or supply of the alcohol;

(c) “relevant person” means, in relation to premises in respect of which there is in force a premises licence—

- (i) the holder of the premises licence,
- (ii) the designated premises supervisor (if any) in respect of such a licence, or
- (iii) the personal licence holder who makes or authorises a supply of alcohol under such a licence;

(d) “relevant person” means, in relation to premises in respect of which there is in force a club premises certificate, any member or officer of the club present on the premises in a capacity which enables the member or officer to prevent the supply in question; and

(e) “value added tax” means value added tax charged in accordance with the Value Added Tax Act 1994.



Brighton & Hove City Council

3. Where the permitted price given by Paragraph (b) of paragraph 2 would (apart from this paragraph) not be a whole number of pennies, the price given by that sub-paragraph shall be taken to be the price actually given by that sub-paragraph rounded up to the nearest penny.
4. (1) Sub-paragraph (2) applies where the permitted price given by Paragraph (b) of paragraph 2 on a day (“the first day”) would be different from the permitted price on the next day (“the second day”) as a result of a change to the rate of duty or value added tax.
(2) The permitted price which would apply on the first day applies to sales or supplies of alcohol which take place before the expiry of the period of 14 days beginning on the second day.

S 21; mandatory condition: door supervision

- I. Where a premises licence includes a condition that at specified times one or more individuals must be at the premises to carry out a security activity, each such individual must:
 - a) Be authorised to carry out that activity by a licence granted under the Private Security Industry Act 2001: or
 - b) Be entitled to carry out that activity by virtue of section 4 of the Act.
2. But nothing in subsection (1) requires such a condition to be imposed:
 - a) In respect of premises within paragraph 8 (3)(a) of Schedule 2 to the Private Security Industry Act 2001 (c12) (premises with premises licences authorising plays or films): or
 - b) In respect of premises in relation to:
 - I. Any occasion mentioned in paragraph 8(3)(b) or (c) of that Schedule (premises being used exclusively by club with club premises certificate, under a temporary event notice authorising plays or films or under a gaming licence) or
 - II. any occasion within paragraph 8(3)(d) of that Schedule (occasions prescribed by regulations under that Act).
3. For the purposes of this section:
 - a) “Security activity” means an activity to which paragraph 2(1)(a) of that Schedule applies, and which is licensable conduct for purposes of that Act, (see Section 3(2) of that Act) and
 - b) Paragraph 8(5) of that Schedule (interpretation of references to an occasion) applies as it applies in relation to paragraph 8 of that Schedule.

Embedded Conditions: None

Variations to Embedded Conditions: All embedded restrictions removed



Annex 2 - Conditions consistent with the Operating Schedule:

For the Prevention of Crime and Disorder:

1. Signage to be clearly positioned on the premises informing customers that they will be refused service if they breach the key policies of the premises relating to the prevention of and/or disorder caused by drug use, intoxication, underage drinking and disorderly behaviour.
2. Licence holders and staff must monitor customer behaviour for breaches of policy and undertake regular walkarounds of the premises not visible to the bar area.
3. Price reductions on drink must be not more than 33% off the premises retail price and will not occur in periods of less than 4 consecutive hours in any day to address binge drinking.
4. SIA registered door staff must be available on a 24 hour emergency basis.
5. A record of refusals of service must be kept in the premises incident book.
6. The Licence holder must support a local crime prevention programme and pub watch scheme.
7. Signage must be clearly positioned on the premises informing customers of a driver's shelf for customers driving and public transport arrangements for customers onward journey.
8. Illumination must be maintained to the exterior areas of the pub after the premises closes to the public.

For Public Safety:

1. Signage must be clearly positioned on the premises to communicate to customers the services available to maintain the comfort and safety of customers with disabilities.
2. Standard glassware will be phased out and replaced with toughened and/or shatterproof glassware.

For the Prevention of Public Nuisance:

1. The Licence holder and staff must undertake regular inspections inside and outside the premises in order to monitor noise levels and ensure that both ambient sound and sound generated by recorded or live entertainment is at a level that does not constitute a nuisance.
2. The licence holder shall ensure that prominent, clear and legible notices are displayed at all exits requesting the public to respect the needs of local residents and to leave the premises and the area quietly. This will also be communicated verbally.
3. All reasonable steps will be taken to ensure that the accumulation of the public awaiting entry to the premises will occur for the minimum time possible with the minimum amount of noise.
4. An additional method of ventilation will be installed to allow for the doors and windows of the pub to remain shut during live music and DJ operated music

For the Protection of Children from Harm:

1. No children except those of personal licence holders engaged at the premises are to be allowed on the premises after 20.00 hours.
2. Licence holders and staff must operate a 'Think 21' policy in that any person attempting to purchase alcohol who appears under the age of 21 will be asked to produce photographic identification.



**Brighton & Hove
City Council**

3. Signage must be clearly displayed informing customers of the premises policy on protection of children from harm and what action will be taken if the policy is breached.
4. Music with explicit lyrical content or any other entertainment taking place before 20.00 hours will be vetted prior to commencement to ensure the content is not unsuitable for children.

Annex 3 - Conditions Attached after a hearing of a Licensing Panel 19th September 2005:

1. The outside area shall be closed and cleared by 23.00 hours.
2. On any day, the provision of live music shall be limited to 10.00 – 23.00 hours.
3. All external doors and windows shall be kept shut after 23.00 hours, except for access and egress
4. The sound attenuator shall be set at a level approved by the licensing authority.
5. The licence holder shall ensure that prominent, clear and legible notices are displayed at all exits requesting the public to respect the needs of local residents and to leave the premises and the area quietly.

Annex 4 – Plans

KEY TO LICENSED AREAS

- * Sale and Supply of Alcohol – on and off sales
- ♪ Regulated entertainment
- ⊙ Hot food after 23.00
- ⊕ Areas made available for consumption outside the premises

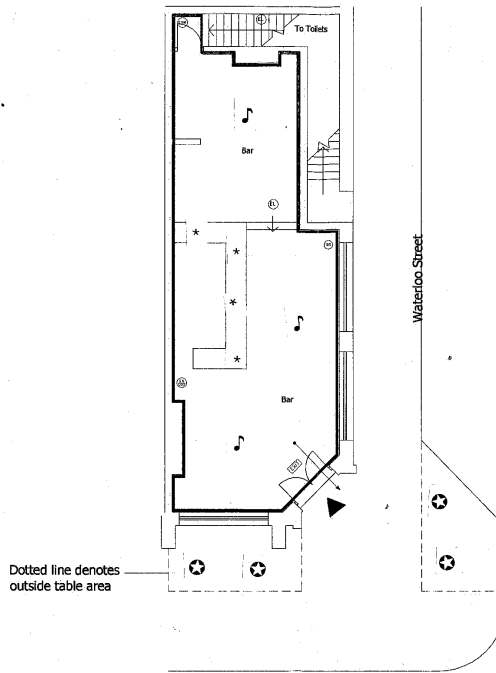

Dotted line denotes outside table area

01 **Ground Floor Plan**
Scale 1:100 @ A3

Copyright © 2014 by the Brighton & Hove City Council. All rights reserved. This document is the property of Brighton & Hove City Council. It is not to be reproduced, stored in a retrieval system, or transmitted in any form or by any means, electronic, mechanical, photocopying, recording, or by any information storage and retrieval system.

- FIRE KEY**
- Ⓜ EMERGENCY LIGHTING
 - Ⓜ HALL DETECTOR
 - Ⓜ SMOKE DETECTOR
 - Ⓜ FIRE EXTINGUISHER WATER
 - Ⓜ FIRE EXTINGUISHER FOAM
 - Ⓜ CO2 EXTINGUISHER
 - Ⓜ FIRE BLANKET
 - Ⓜ EMERGENCY EXIT SIGN
 - Ⓜ BREAK GLASS UNIT
 - TRAVEL DISTANCE
 - Ⓜ REEL SOURCE
 - ▼ ENTRANCE

| | |
|------------|----------------------------------------|
| PROJECT | THE JUGGLER 21 WESTERN ROAD HOVE |
| DATE | 14.06.06 |
| DRAWING NO | 1026-03 |
| SCALE | 1:100 |